

論文 / 著書情報  
Article / Book Information

論題(和文)	ネパールのレンガ壁を有するRC 建物の耐震性能評価 (その1) レンガ壁の要素実験
Title(English)	Seismic Performance Evaluation of an RC Building with Brick Walls in Nepal Part 1 Experiments of Brick Walls
著者(和文)	PRADHAN SUJAN, 福井紳矢, 片山遥, 真田 靖士, 楠浩一
Authors(English)	PRADHAN Sujan, FUKUI Shinya, KATAYAMA Haruka, SANADA Yasushi, KUSUNOKI Koichi
出典(和文)	日本建築学会大会学術講演梗概集, , , pp. 901-902
Citation(English)	, , , pp. 901-902
発行日 / Pub. date	2017, 8
権利情報	一般社団法人 日本建築学会

## Seismic Performance Evaluation of an RC Building with Brick Walls in Nepal Part 1 Experiments of Brick Walls

Masonry wall	Nonlinear analyses	Nonstructural wall	member	○PRADHAN Sujan <sup>1</sup>	member	SANADA Yasushi <sup>2</sup>
Reinforced concrete	Seismic performance	Strut replacement	member	FUKUI Shinya <sup>1</sup>	member	KUSUNOKI Koichi <sup>3</sup>
			member	KATAYAMA Haruka <sup>1</sup>		

### 1. Introduction

On April 25, 2015, at 11:56 (Nepal local time), a 7.8 magnitude earthquake hit Nepal. Many reinforced concrete (RC) buildings in urban areas especially at Kathmandu were damaged by this earthquake [1]. In Nepal, brick masonry walls are widely used as exterior and partition walls in RC buildings.

According to the Nepalese design standards [2], brick masonry walls are regarded as non-structural elements that do not affect the structural performance of buildings. However, previous studies [e.g. 3] have shown that masonry walls also contribute to strength and deformation performance of RC frames. Therefore, this study investigates brick masonry contributions to the seismic performance of an RC building in Kathmandu.

### 2. Target building for study

The target building is located in the capital city of Nepal, Kathmandu. **Figure 1** shows the location map of the building. The building has five stories above ground (superstructure) and one underground (substructure) with mat/raft foundation. Originally, this building was designed as a 3-story building but it was extended to 5 stories during construction. **Picture 1** shows the northeast and southeast views of the building, and **Figure 2** shows the ground floor plan and the sectional elevation along the X-X axis [4].

The exterior brick walls on the northwest side in the longitudinal direction of the building had plaster finishing on both sides, while the walls on the southeast side had plaster finishing on one side.

### 3. Experiment of brick masonry prisms

Brick masonry prism specimens were prepared as per the brick masonry walls used in the target building. The specimens were prepared by masons who were engaged in the construction of

the target building with the same materials and process as those of the target building. In order to obtain the strengths and elastic moduli of the brick masonry walls, the following experiments were conducted.

### 3.1 Experimental methods

To determine the effects of plaster finishing on the structural characteristics of brick masonry walls, three kinds of specimens with three different types of plaster finishing (PN without plaster, PO with plaster on one side, PB with plaster on both sides) were prepared as shown in **Figure 3**. The used bricks were burnt brick of the size of 220 mm × 110 mm × 55 mm. The mix proportion of joint mortar was a cement: sand ratio of 1:4 with water to cement ratio of approximately 0.85 and that of plaster mortar was a cement: sand ratio of 1:5 with water to cement ratio of approximately 0.85. However, the water to cement ratio was not measured accurately, as it was arranged by the experience of the masons.

The experiments were conducted at the Material Laboratory in Tribhuvan University, Pulchowk Campus by using Universal Testing Machine (UTM). The measurements were applied loads, and strains in horizontal and vertical directions. The strains in the horizontal and vertical directions were measured by using displacement transducers attached to the specimen as shown in **Figure 4**. **Picture 2** shows the photograph of the specimen during the experiment.

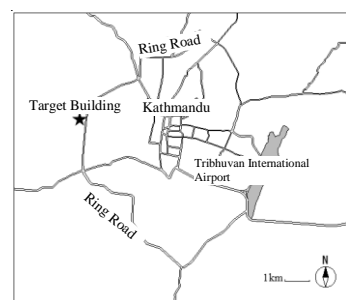

**Figure 1**  
Location map of target



**Picture 1** Overview of target building

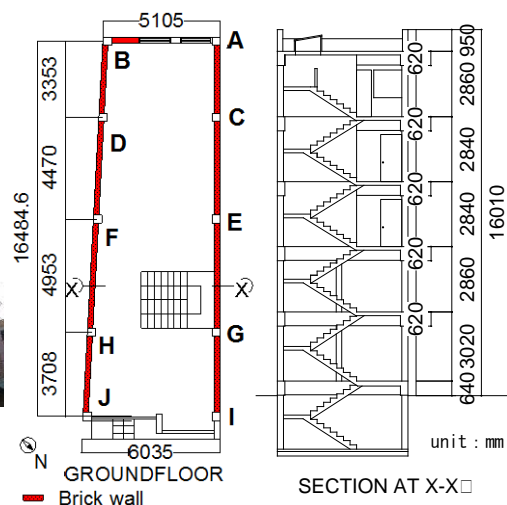

**Figure 2** Ground floor plan and elevation

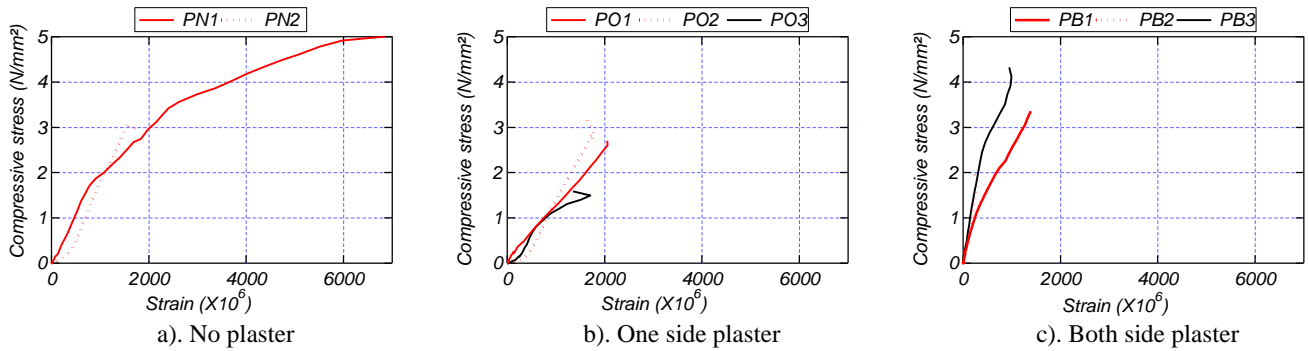

Figure 5 Stress-strain relationship

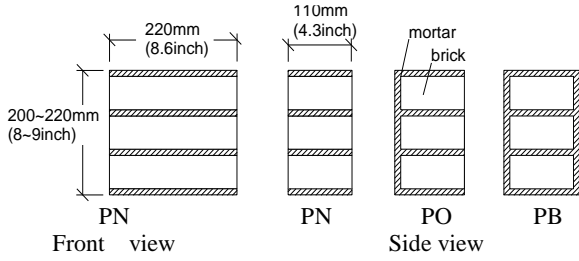

Figure 3 Specimen dimensions

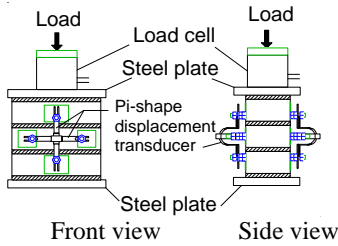

Figure 4 Test setup



Picture 2 Experiment

Table 1 Results of compression tests

	Elastic Modulus (N/mm <sup>2</sup> )	Compressive Strengths (N/mm <sup>2</sup> )
PN1	2192	5.1
PN2	2278	3.0
Average	2235	4.1
PO1	2108	2.7
PO2	2032	3.2
PO3	1935	1.6
Average	2025	2.5
PB1	4777	3.4
PB2	5394	2.0
PB3	6506	4.3
Average	5559	3.2

strengths of brick masonry prism specimens with three types of plaster finishing were obtained. The elastic modulus was significantly higher in the case with plaster on both sides, while the compressive strength was not affected by the plastering work.

[Acknowledgement]

The project was funded by J-RAPID (Project title: Field investigation research to improve seismic capacity of new and existing Nepalese buildings, Project leader: Associate professor Kusunoki Koichi, the University of Tokyo). The authors are greatly thankful for the supports.

[Reference]

- [1] Architectural Institute of Japan, 2016: Reconnaissance Report on the 2015 Nepal Gorthka Earthquake.
- [2] Nepal National Building Code NBC 205:1994.
- [3] Naruhito YAMAUCHI et al Effects of non-structural block infill on seismic performance of RC frame, Proceedings of the Japan Concrete Institute, Vol.29, No.3, pp. 925-930, 2007.7
- [4] Haruka KATAYAMA et al.: Observation and Analysis on Vibration Characteristic of an RC building with brick walls in Nepal, Proceedings of the Japan Concrete Institute, Vol.38, No.2, pp. 1495-1500, 2016.7

3.2 Experimental results

This paper reports the compression test results of the prism specimens, which will be used in the analysis of Part 2. The values of the elastic moduli and compressive strengths from the tests are shown in Table 1, where the compressive strength was calculated by dividing the maximum load by the gross cross-sectional area of the specimen. The compressive stress-strain relationships are shown in Figure 5, where the compressive strain was obtained by dividing the output of the displacement transducer by its gauge length. The elastic modulus on Table 1 was the initial slope with approximate linear stiffness of the stress-strain relationships in Figure 5. From the table, we can see that the elastic modulus of PB series with plaster on both sides was significantly higher than those of PN and PO series with plaster on one side and without plaster, respectively. However, the compressive strength was not affected by the presence of plaster.

4. Summary

From the experiments, the elastic moduli and compressive

<sup>1</sup> Graduate Student, Graduate School of Eng., Osaka University

<sup>2</sup> Assoc. Prof., Graduate School of Eng., Osaka University, Dr. Eng.

<sup>3</sup> Assoc. Prof., Earthquake Research Institute, The Univ. of Tokyo Dr. Eng.

<sup>1</sup> 大阪大学大学院 工学研究科 大学院生

<sup>2</sup> 大阪大学大学院 工学研究科 准教授・博士 (工)

<sup>3</sup> 東京大学 地震研究所 准教授・博士 (工)